

# Top End® QR.2G Chair

## Price List and Order Form

Effective January 15, 2009

For accuracy of ordering, please fax order to Top End at 727-522-1007 or e-mail to TopEndOrders@invacare.com

For questions call 800-532-8677 or 727-522-8677.

To order Literature: 800-828-6282

www.topendwheelchair.com



Provider Name \_\_\_\_\_ Date \_\_\_\_\_ Top End Job Number \_\_\_\_\_  
 Account # \_\_\_\_\_ P.O. # \_\_\_\_\_ Phone # \_\_\_\_\_ Fax # \_\_\_\_\_  
 Address \_\_\_\_\_ City \_\_\_\_\_ State \_\_\_\_\_ Zip Code \_\_\_\_\_  
 Customer Name \_\_\_\_\_ Email \_\_\_\_\_ Phone No \_\_\_\_\_  
 Address \_\_\_\_\_ City \_\_\_\_\_ State \_\_\_\_\_ Zip Code \_\_\_\_\_  
**Ship order to:**  Provider  Customer **Order will ship to Provider unless otherwise noted.**

### KEY MEASUREMENT GUIDELINES PAGES 2 & 3

- QR20** Top End Aluminum Quad Rugby Offensive Chair..... \$4,500.00
- QR2D** Top End Aluminum Quad Rugby Defensive Chair.....\$4,250.00

### Offensive Standard Options:

- Offensive Wing / Bumper
- Integral Aluminum Pushrim w/ Welded Aluminum Spoke Guards
- Rounded Back Posts
- Double Padded Adj. Tension Back Upholstery
- Double Anti-tip fixed (swivel) and Guard

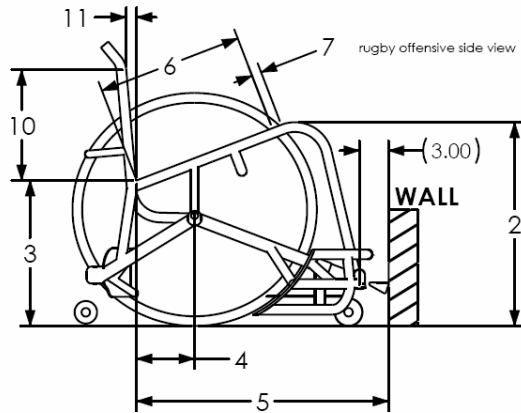

### Defensive Standard Options:

- Defensive Picker
- Rubber Coated Pushrims w/ Black Plastic Spoke Guards
  - STD. Mount  Close Mount
- Rounded Back Posts
- Double Padded Adj. Tension Back Upholstery
- Double Anti-tip fixed (swivel) and Guard

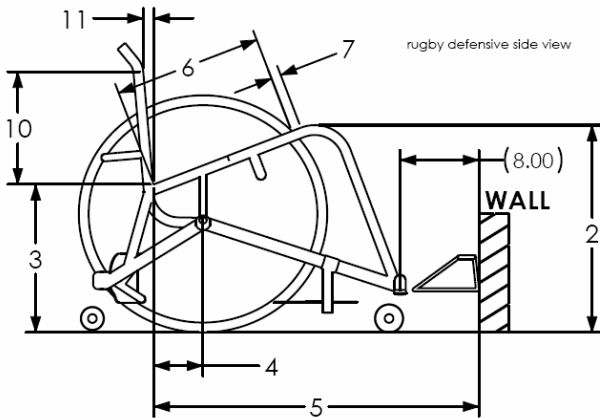

1. **SEAT WIDTH** 14" 14.5" 15" 15.5" 16" 16.5" 17" 17.5" 18" 18.5" 19" 19.5" 20" 20.5" 21"

- TER1** Tapered seat width.....125.00 <sup>1</sup>  
 Rear Seat Width: \_\_\_\_\_ Front Seat Width: \_\_\_\_\_

### ERGO SEAT OPTION:

- TED104** Ergo Seat w/Tapered Front End.....\$250.00
- TED110** Ergo Seat w/V Style Front End.....\$350.00

### FOOTREST: Recessed Footrest (Adjustable Height, Angle, Fore to Aft)

2. **SEAT HEIGHT FRONT:** 14.5" 15" 15.5" 16" 16.5" 17" 17.5" 18" 18.5" 19" 19.5" 20" 20.5" 20-7/8" (53cm)

3. **SEAT HEIGHT REAR:** 13" 13.5" 14" 14.5" 15" 15.5" 16" 16.5" 17" 17.5" 18" 18.5" 19" 19.5"

4. **AXLE POSITION:** "CENTER OF GRAVITY"(choose fixed or adj.): <sup>3</sup>  
 Fixed Axle Position:  3"  3.5"  4"  4.5"  5"  5.5"  6" Other \_\_\_\_\_  
 Adjustable Center of Gravity Range:  2" to 4"  3" to 5"(Std.)  4" to 6" <sup>4</sup>

5. **FRONT TO WALL:** (Beginner's guideline: SD+11 for Off., SD+18 for Def.)

- Offensive 25" 25.5" 26" 26.5" 27" Other \_\_\_\_\_  
 Defensive 32" 32.5" 33" 33.5" 34" Other \_\_\_\_\_

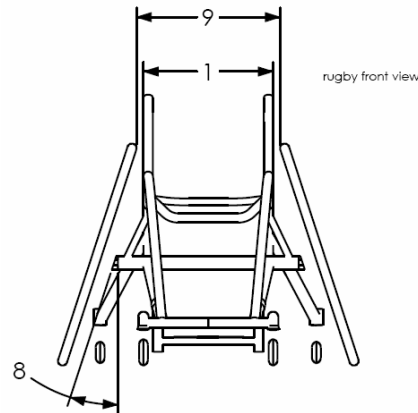

6. **UPHOLSTERY SEAT DEPTH:** 14" 15" 16" 17" 18"

7. **EXTRA FRAME DEPTH:** Standard = 0": 1" 1 1/2" 2"

8. **CAMBER:** 12° 15° 18° 20° (no other camber available)

9. **WHEEL DISTANCE:** Standard = Seat Width + 1.5"  Other \_\_\_\_\_

- WHEEL TYPE: Build for:**  Standard or  Spinergy

### SUN®PERFORMANCE REAR WHEELS/ PRIMO TIRES:

- Rear Wheel Size:**  24"(540)  25"(559)
- TER131** Spinergy™ SLX (4mm) upgrade (24 spokes) .... 895.00  
 Spoke color: (choose one)  Black  Yellow  White  Red  Blue
  - TER67** Spinergy Spox (3mm) upgrade (24 spokes)..... 695.00  
 Spoke color: (choose one)  Black  Yellow  White  Red  Blue
  - TER101** Kenda® Tires:  Red or  Yellow..... 75.00

### 10. BACK HEIGHT (choose fixed or adjustable):

- Fixed Height:  8"  8.5"  9"  9.5"  10"  10.5"  11"  11.5"  12"  12.5"  13"  13.5"  14"  14.5"  15"  15.5"

- Adjustable Height Range:  
 Short 9" to 11"  Low 11" to 14"  Med 14" to 18"

### 11. BACK ANGLE (specify 'Degrees or 'Inches from vertical)

- Degrees: 5 7 10 other \_\_\_\_\_ **OR** Inches from vertical: \_\_\_\_\_

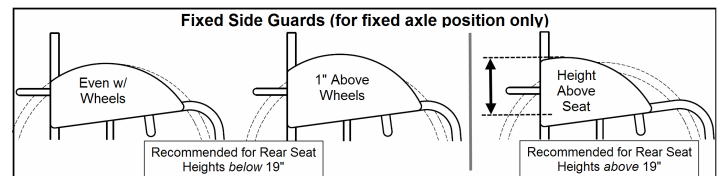

**Top End® QR.2G Chair**

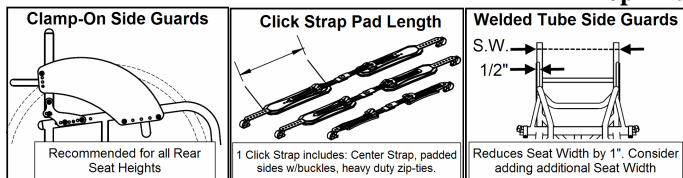

(A) Measure existing Seat Width (shown in front view page 1). Determine if you desire more or less. Use a tape measure to estimate the amount of change desired. 1/2" sizes are acceptable. The Tapered Seat Width option divides the seat into a Rear Seat Width and a Front Seat Width. A small amount of taper would be 1 to 2 inches, more common for single leg amputees. A larger amount of taper would be 3 to 4 inches and would be common for legs with significant atrophy. (See footnote #1)

(B) The only major mistake one can make with Seat Width is to order it too narrow. 15" and 16" are the two most common Seat Widths. If no chair is available, measure the distance by pressing two books to the outsides of one's hips and measuring the distance between them. (See footnote #1)

**4. Footrest Type:**

Recessed Footrest is height and angle adjustable, and is also adjustable forward and backward to maximize the ability to create the ultimate ball pocket. Footrest Width is approximately Seat Width minus (-) 4".

**Seat Height Front / Rear:**

**Footnote #2:** Rear Seat Height: 13" available with 24" wheels only.

(A) Measure the Front and Rear Seat Heights as shown in side view page 1. Use a tape measure to estimate the amount of change desired. Measured Seat Heights may be affected by tire pressure, wheel size, after-market tires, and axle receiver position.

(B) Rear Seat Height typically plays a more significant role in chair performance than Front Seat Height. It is recommended for inexperienced end users to try existing wheelchairs to understand the difference between Rear Seat Heights. Taller Rear Seat Heights enable users to reach higher, but in most cases reduce their mobility

**9. Axle Position (Center of Gravity):**

**Footnote #3:** Measure the user's existing chair from the *Front* of the Back post, horizontally (as shown in side view pg 1), to the center of the rear axle.

**Footnote #4:** Adjustable Center of Gravity: Non-folding, angle adjustable backrest. If side guards are desired, Clamp-on style is the only compatible option.

(A) The two largest contributors to the responsiveness of a sports wheelchair are the frame's Axle Position and the "sag" in the upholstery. Both of these contributors determine where the user's body is positioned relative to the rear wheels. When a Fixed (welded in this case) Axle Position is chosen, the upholstery can be expected to provide roughly 1" to 1 1/2" of adjustment. If more adjustment is found to be required, additional width back upholstery can be purchased through Top End customer service. Choosing an Adjustable Center of Gravity range (shown on pg.1), adds an additional 2" of adjustment to the upholstery (1" - 1 1/2"). There are more side guard options currently available with a fixed Axle position.

(B) Choosing an Adjustable Center of Gravity of 3" to 5" provides a good range for new users.

**Camber:**

(A) & (B) 15° is a conservative camber and makes for a thinner overall chair base. Taller players find this advantageous when trying to fit through tight spaces on the court. 18° and 20° create a wider overall chair base, and are advantageous for offensive players.

**Rear Wheel Size, Options:**

(A) Existing Wheel size can be determined by reading the side-wall of the tire currently used or comparison with a wheel whose size is known. Wheel size is a player preference. Larger sizes may provide faster overall speed, but slower starts. Smaller size wheels may provide faster starts, but slower overall speed. Choosing the end user's existing wheel size is the most conservative choice.

**Side Guards: (refer to diagrams)**

**Footnote #12:** When Fixed Axle position chosen, all Side Guards are available. When Adjustable Center of Gravity is chosen, the Clamp-on Fixed Style are the **only** available side guards.

**Footnote #14:** Welded tube Side Guards will reduce Seat Widths by 1/2" each side.

(A) If Side Guards are desired, measure the height of the existing Side Guards from top of seat frame (See footnotes #12, 13 &14)

(B) Side Guards are common for sports wheelchairs. All Non-Welded Side Guards are removable. If the end user is not comfortable with the side guards, they can always be taken off. Welded Side Guards are permanent, and are intended for the advanced user.

**SIDE GUARDS:**

- TER95** Clamp-On Fixed aluminum side guards.....\$125.00
- TER20** Fixed aluminum side guards .....\$175.00 <sup>5</sup>
  - Even w/wheels  1" Above wheels  Height above seat \_\_\_\_\_
- TER130** Welded aluminum tube side guards w/ welded aluminum panel <sup>5,6</sup>
  - Even w/wheels  1" Above wheels  Height above seat \_\_\_\_\_

**SAFETY AND COMFORT OPTIONS:**

- Calf Strap / Frame protector – rear.....Standard
- Cushion, soft  2"  3" .....75.00
- TER37** Frame protectors – front.....40.00
- XLT33** Alignment gauge.....75.00
- TER126** Click strap large (pad length ~12").....86.00
- TER125** Click strap medium (pad length ~10").....80.00
- TER124** Click strap small (pad length ~8").....75.00
- TER128** D-Ring positioning belt.....100.00
- RACE22** Top End T-Shirt,  L  XL.....10.00

Special Instructions: \_\_\_\_\_  
 \_\_\_\_\_  
 \_\_\_\_\_  
 \_\_\_\_\_  
 \_\_\_\_\_

specials pss jan09

**FRAME COLOR AND UPHOLSTERY**

**UPHOLSTERY**  Black STD  UPHI Camouflage \$100.00

**FRAME FINISH:**  Bead Blast Finish for Titanium

**CONTEMPORARY COLORS**

- Wet Black  Black Prism  White Snow
- Silver Metallic  Silver Vein  Copper Penny

**WAY COOL COLORS**

- Electric Blue  Midnight Blue  Cosmic Blue
- Electric Teal  Emerald Green  Grasshopper Green

**TOO HOT COLORS**

- Tangerine Red  Electric Red  Grape Madness
- Safety Yellow  Sunkissed Orange  Fruit Fusion

**ADVICE FROM PAUL SCHULTE:**

"The most experienced athletes I know are *still* considering changes for their *next* sports product. Changes are exciting, and in some cases enhance the performance of the athlete. Too many changes at once, however, make it difficult for athletes to determine what helped and what did not. Athletes should be conservative in the number of changes made when ordering a new product, and patient when experiencing what they have ordered. I have made changes that I initially disliked, which eventually became the best things for me."

-Paul Schulte, Gold Medalist, Top End Design Engineer

**GUIDELINE KEY**

**Footnote # :** Footnotes (Exclusions) applicable to the measurement / option.  
**(A):** For user's who have a sports wheelchair present during measurement.  
**(B):** For user's who do not have a sports wheelchair present during measurement.

key pss jan09

**1. Seat Width:**

**Footnote #1:** When Tapered Seat Width is chosen, 4" is the maximum difference between Rear and Front Seat Widths. Footrest width will be 2" less than the specified Front Seat Width.

**Invacare Corporation**

**TOP END**  
 Sports and Recreation Products  
 4501 63<sup>rd</sup> Circle North Pinellas  
 Park, FL USA  
 33781-5914

www.invacare.com

All rights reserved. Trademarks are identified by the symbols <sup>TM</sup> and <sup>®</sup>. All trademarks are owned by or licensed to Invacare Corporation unless otherwise noted.  
 Spinerigy is a registered trademark of Spinerigy, Inc.  
 Kenda is a registered trademark of Kenda Rubber Industrial Co. Ltd.  
 Specifications and prices are subject to change without notification.  
 ©2008 Invacare Corporation



**Yes, you can.®**